



simma™

POOLS
& SPAS

SPAS

Discover our collection

Wellis®

Standards features

- Stainless steel hydrotherapy jets
- Ergonomic headrests
- LED footwell light
(N/A on the Milano)
- LED Interior perimeter lighting
- LED Exterior corner lighting
(N/A on the Milano)
- 2 Lighted fountain jets
- Lighted waterfall (Vienna and Malaga only)
- HorizontSide™ UV-Proof Wood Texture Cabinet
- Special polymer WPS frame
- Scandinavian insulation
- Thermal cover 5 in – 3 in taper
- Gecko electronic control
- 2 single speed pumps and 1 circulation pump
(1 pump with 2 speeds on the Milano)
- 4kw heating system
(1kw on the Milano)
- Antibacterial 3 cartridge filtration system
- Ozmix™ sanitation system

ACRYLIC



Sterling
silver



Ice
white



Tuscan
sun



Midnight
canyon

CABINET



Brown







Grey









Model Vienna

-  7 seats
-  62 jets
-  91 in x 91 in x 35 in
-  1298 L | 343 Gal
-  848 lbs | 385 kg (empty)







Model Lugano

-  5 seats + 1 bed
-  52 jets
-  91 in x 91 in x 35 in
-  1382 L | 365 Gal
-  853 lbs | 387 kg (empty)





Model Lima

-  7 seats
-  40 jets
-  86 in x 86 in x 35 in
-  1298 L | 343 Gal
-  739 lbs | 335 kg (empty)







Model Malaga

-  5 seats + 1 bed
-  40 jets
-  86 in x 86 in x 35 in
-  1200 L | 317 Gal
-  739 lbs | 335 kg (empty)



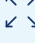

Model Milano

-  4 seats + 1 bed
-  36 jets
-  85 in x 75 in x 34 in
-  965 L | 255 Gal
-  618 lbs | 280 kg (empty)

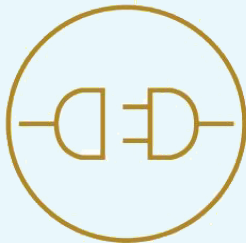

Plug & Play

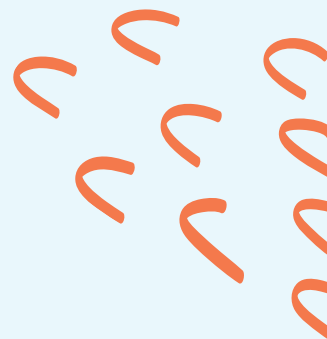

Standards features

- Stainless steel hydrotherapy jets
- Ergonomic headrests
- LED Interior perimeter lighting
- 2 Lighted fountain jets
- HorizontSide™ UV-Proof Wood Texture Cabinet
- Special polymer WPS frame
- Scandinavian insulation
- Thermal cover 5 in - 3 in taper
- Gecko electronic control
- 1 single speed pumps and 1 circulation pump
- 4kw heating system
- Antibacterial 3 cartridge filtration system
- Ozmix™ sanitation system

ACRYLIC



Sterling silver

Ice white

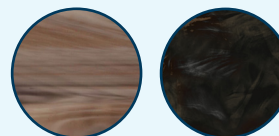

Tuscan sun

Midnight canyon





CABINET



Grey



Model Hercules

-  5 seats + 1 bed
-  45 jets
-  85 in x 85 in x 36 in
-  1249 L | 330 Gal
-  728 lbs | 330 kg (empty)



Wellis is constantly innovating, developing new technologies to offer you a better wellness experience while reducing energy consumption as much as possible.

Scandinavian insulation

3.5 cm of POLYFOAM panels were installed and welded together in the structure of the spa to obtain a better thermal performance.



WPS frame

The special polymer ensures exceptional stability and life for the spa's structural frame



W-EC circulation pump

Its low power consumption, long life, and quiet operation make it environmentally friendly and cost-effective.



OZMIX™ Ozone

Disinfection effectiveness can be increased by mixing ozone with water. The OZMIX™ system has proven to be more effective than comparable disinfection systems with added chlorine and balanced pH.

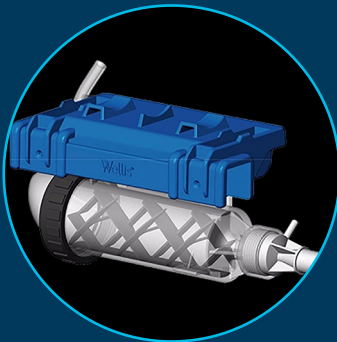

Poli-Max reinforcement

1. Acrylic outer surface with antimicrobial treatment
2. ABS polymer layer to further increase impact resistance and strength
3. Robotically applied polyurethane for added strength plus acoustic and thermal insulation.

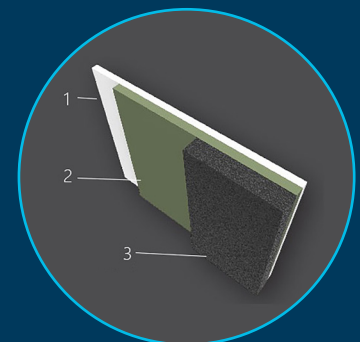



*sima*TM
POOLS
& SPAS

#MK2142-WEL